

NET DRUM

Type N-109

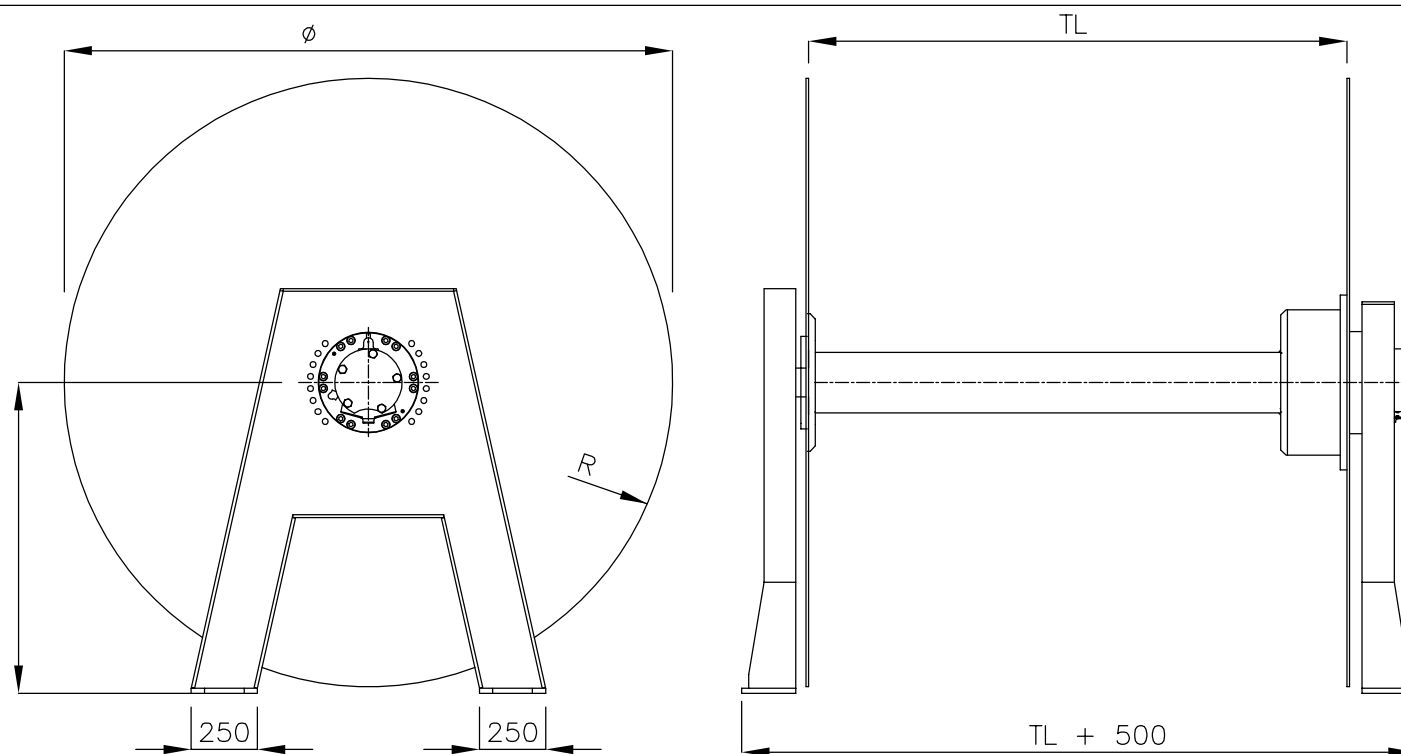

Specifications – NET DRUM N-109-01 MS50 Standard

| | | | | |
|-----------------|------------|---------------|--------------------------------|---|
| Motor | : Poclairn | Drumplate | : 10 mm veldox 700 | Capacity: |
| Motortype | : MS50 | Drumdimension | : ϕ x $\phi 229$ x mm. | $(R^2 \text{ in m} \times 3.14 - 0.06) \times TL \text{ in m} = \text{m}^3$ |
| Pull at 250 bar | : 16 ton | Brake | : Hydraulic brakevalve | Surface Sandblasted, metallized + 2 componet paint |

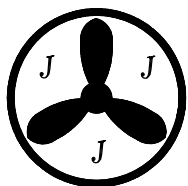

Thyborøn Skibs & Motor A/S
Tlf. (+45) 96 900 100

Beddingsvej 5
 7680 Thyborøn Havn
 Fax: (+45) 97831982
 E-mail: 3xj@3xj.dk
 www.3xj.dk